

ACE DEUCE  
CONVERSION

*M* MANITOU



## MANITOU

---

5800 W Donges Bay Rd  
Mequon, WI 53092

[manitoumtb.com](http://manitoumtb.com)

888.686.3472

Support: [manitoumtb.com/support](http://manitoumtb.com/support)

## WARRANTY

---

For full warranty information please visit  
[hayesbicycle.com/warranty](http://hayesbicycle.com/warranty)

**HAYES**

**M**  
MANITOU

**PROTAPER**

**REYNOLDS**

**SUN**  
ringlé

# INTRODUCTION

This guide provides details on the Ace lever for cable-actuated dropper seat posts and Deuce lever for cable-actuated suspension lockout systems. This guide also provides instructions for assembly, disassembly, adaptation, and conversion of the various lever systems within the Ace/Deuce family.

The Ace and Deuce levers may be mounted directly to a handlebar using the included 22.2mm hinged clamp. With the hinged bar clamp removed, the Ace and Deuce lever assemblies are also compatible with integrated brake mounts that use the MatchMaker X interface, like the Hayes Peacemaker.

Further guidance on installing and setting up the Ace and Deuce lever systems can be found within the service guides for the Manitou Jack dropper seat post, Manitou R8 Pro fork, and Manitou Mara Inline shock.

<b>Hayes Bicycle USA</b>	5800 W Donges Bay Road Mequon WI 53092
	Phone: 888.686.3472
	Email: techsupport@hayesbicycle.com

<b>Hayes Bicycle Europe</b>	Dirnismaning 20 a 85748 Garching (b. Munich) Germany
	Phone: +49 89 203237450
	Email: techsupportEU@hayesbicycle.com

<b>Hayes Bicycle Asia</b>	16F, No. 37, Sec. 3 Mincyuan E. Rd. Zhongshan District Taipei City 10476 Taiwan ROC
	Phone: 886-2-2518-1108

# TABLE OF CONTENTS

---

SECTION	PAGE NUMBER
Lever Configurations	5
Required Tools	5
Lever Disassembly	6
Track Plate Replacement (Deuce Lever)	8
Lever Assembly	9
Torque & Threadlock Specifications	12
Kit List	13
Compatible Product List	14

# LEVER CONFIGURATIONS

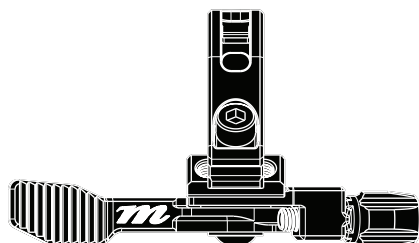

Ace (Dropper) p/n 193-41336-A101

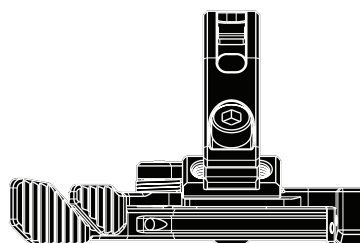

Deuce (Lockout) p/n 193-41336-A201

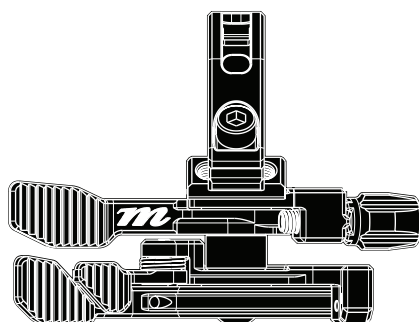

Ace/Deuce (Lockout and Dropper) p/n 193-41336-A001

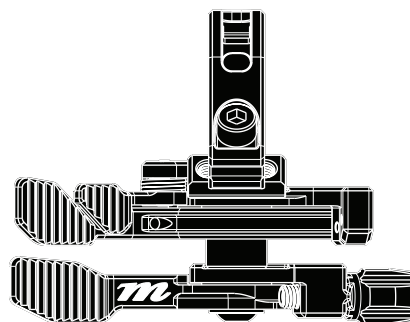

Deuce/Ace (Lockout and Dropper) p/n 193-41336-A001 (modified orientation)

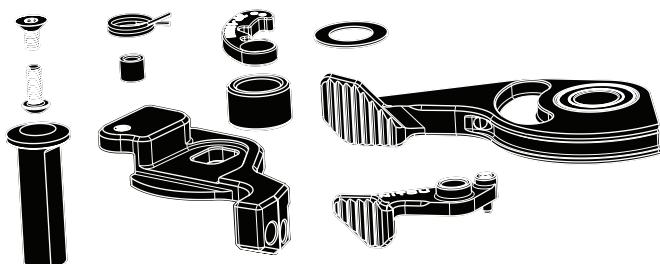

Ace Conversion (Convert Ace to Ace/Deuce or Deuce/Ace) p/n 193-41336-K005

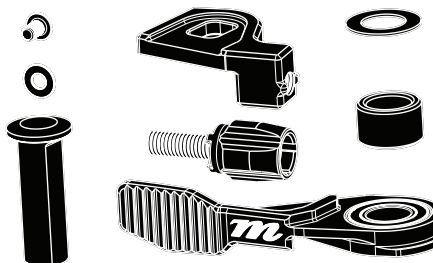

Deuce Conversion (Convert Deuce to Ace/Deuce or Deuce/Ace) p/n 193-41336-K006

## REQUIRED TOOLS

- Safety glasses
- Torque Wrench (6-220 in-lb [0.7-5 Nm])
- 3mm Hex Key
- 4mm Hex Key
- T10 Torx Key

# LEVER DISASSEMBLY

- 1 The following instructions can be used to disassemble any configuration of the Ace/Deuce lever system. If necessary, disconnect all cables attached to the lever assembly before proceeding.

Loosen the bar clamp screw with a 4mm hex key, rotating counter-clockwise. Remove the bar clamp and screw. Set both parts aside for future use.



- 2 Loosen the main pivot screw with a 3mm hex key, rotating counter-clockwise. Pinch the main pivot pin and the main lever together to prevent the assembly from falling apart. Finish loosening the main pivot screw, remove the screw, and set it aside for future use.



- 3 Pull the main lever and thin washer off the main pivot pin. Set both parts aside for future use.



# LEVER DISASSEMBLY

**4** Remove the base plate from the main pivot pin.

Note: The pivot pin may require some force to push out of the base plate. Do not strike the pivot pin directly with a hammer or other blunt object, as this may damage the pivot pin.

For a short pivot pin configuration (Ace or Deuce), lever disassembly is now complete. For long pivot pin configuration (Ace/Deuce or Deuce/Ace), proceed to LEVER DISASSEMBLY, Step #5.

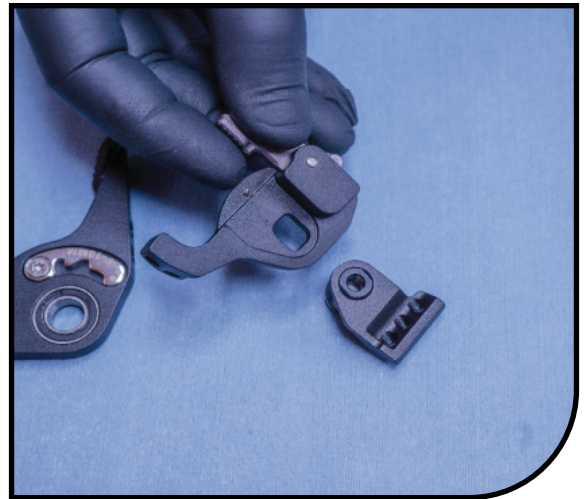

**5** Remove pivot pin from base plate by pressing the pin straight up. This pivot pin is keyed to prevent it from twisting, note the orientation.





# CHANGING TRACK PLATE

- 1 The Deuce lever includes a separate part that interfaces with the release lever, known as the track plate. If track plate replacement or reconfiguration is not required, skip to “LEVER ASSEMBLY” starting on page 9.

After disassembling the main Deuce lever from the assembly, hold the Deuce lever in one hand and loosen the track plate screw with a T10 torx key, rotating counter-clockwise. Remove the screw and set aside for future use.



- 2 Remove the track plate from the Deuce lever. For a general service, inspect the teeth on the track plate for excessive wear and replace if necessary.

NOTE: Track plates are laser etched with the corresponding number of damper positions and the designed cable pull length. Note that all remote-compatible Manitou forks and shocks utilize a cable pull length of 18mm.



- 3 Insert the track plate into the corresponding groove on the Deuce lever. When installed correctly, the countersink for the screw hole and the laser-etched text on the track plate should be visible.

Insert the track plate screw into the track plate and lock lever. Tighten the screw to 1.5-1.8 Nm [13-16 in-lb] using a T10 torx key, rotating clockwise.





# LEVER ASSEMBLY

- 1 Two lengths are available for the main pivot pin: the short pin is used for the Ace lever and Deuce lever while the long pin is used for the stacked Ace/Deuce or Deuce/Ace assemblies. Select the appropriate pin for the desired lever configuration.

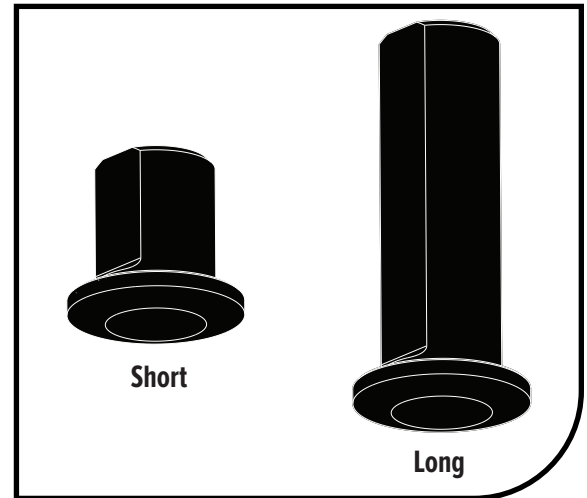

- 2 Insert the main pivot pin into the through-hole of the mounting plate.



- 3 Collect the base plate that matches the desired lever configuration. Orient the main pivot pin to the keyed hole of the base plate. Push the pivot pin into the base plate.



# LEVER ASSEMBLY

- 4** Install the thin washer on the main pivot pin.



- 5** Install the main lever to the main pivot pin.

For the Deuce lever, the release lever needs to be oriented to the lock lever as the lock lever is pushed onto the main pivot pin.

If using a short pivot pin (single lever configuration), skip to LEVER ASSEMBLY, Step #8, for assembly of the main pivot screw.

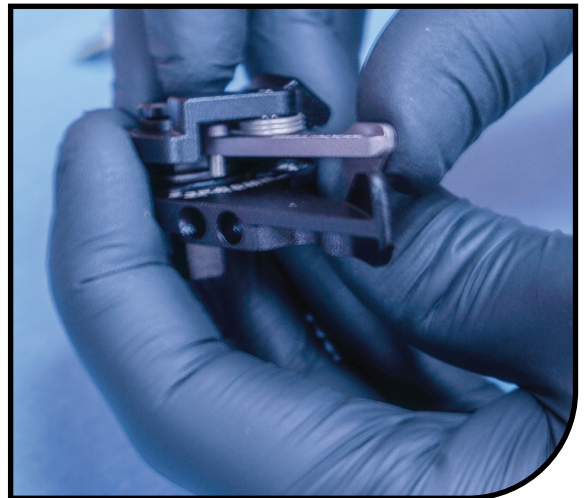

- 6** For long pivot pin configurations (Ace/Deuce or Deuce/Ace), install the spacer on the main pivot pin.



# ASSEMBLY LEVER STACK

- 7** For Ace/Deuce or Deuce/Ace assembly, install the second set of base plate, thin washer, and lever



- 8** Apply medium strength (blue) threadlock to the main pivot screw.

Insert the main pivot screw into the main pivot pin. Grasp the lever assembly in one hand and tighten the main pivot screw to 4.0-4.5 Nm [35-40 in-lb] using a 3mm hex key, rotating clockwise.

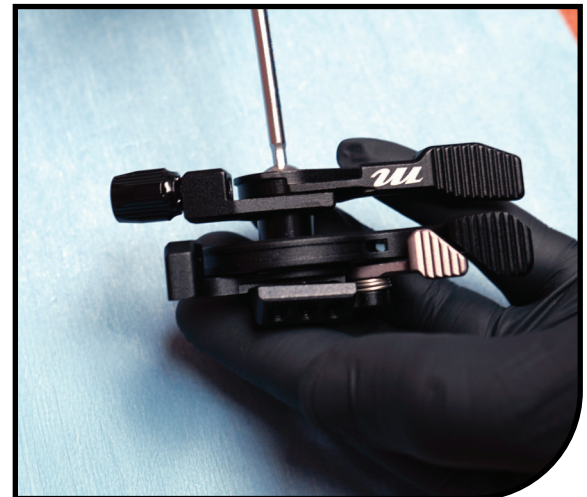

- 9** Install the finished lever assembly onto the bike. For handlebar mounting, install the bar clamp around the handlebar, insert the clamp screw into the clamp, and align the screw with the lever mounting plate. Tighten the bar clamp screw to 4.0-5.0 Nm [35-44 in-lb] with a 4mm hex key, rotating clockwise.

For direct mounting to an integrated brake clamp, consult the manufacturer's installation/service guide.

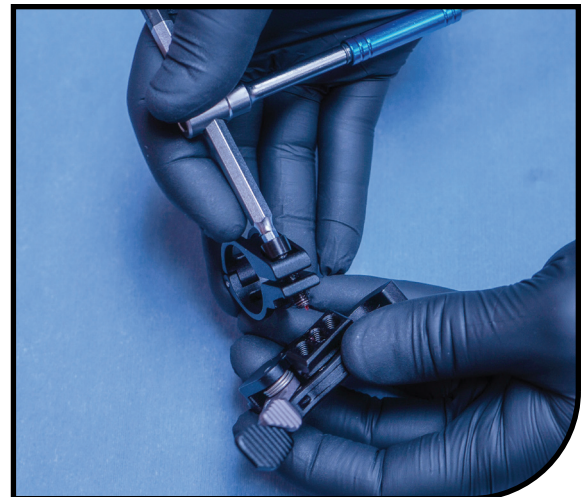

# TORQUE AND THREADLOCK SPECIFICATIONS

Torque and Threadlock Chart				
SPEC	APPLICATION	THREADLOCK	TOOL INTERFACE	Torque Specification
A	MAIN PIVOT SCREW	P/N 050525 ( BLUE, MEDIUM STRENGTH)	3MM HEX (INTERNAL)	4.0 - 4.5 Nm (35-40 IN-LBF)
B	BARREL ADJUSTER	NONE	NONE	1.0 Nm Max (9 IN-LBF Max)
C	CABLE PINCH SCREW	NONE	T10 TORX (INTERNAL)	1.0 Nm Max (9 IN-LBF Max)
D	UNLOCK LEVER PIVOT SCREW	P/N 050526 (RED HIGH STRENGTH)	T10 TORX (INTERNAL)	0.9 - 1.1 NM (8-10 IN-LBF)
E	TRACK PLATE SCREW	NONE	T10 TORX (INTERNAL)	1.5-1.8 Nm (13-16 IN-LBF)
F	BAR CLAMP SCREW	NONE	4MM HEX (INTERNAL)	1.0 Nm Max (9 IN-LBF Max)

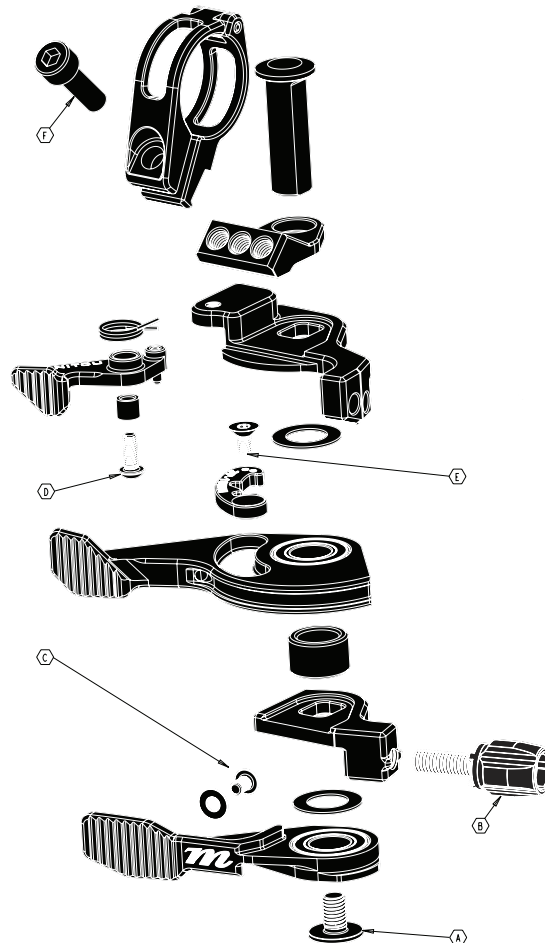

# KIT LIST

KIT DESCRIPTION	KIT NUMBER
KIT, DEUCE TRACK PLATES 18MM	193-41336-K001
KIT, CONVERSION, ACE LEVER	193-41336-K004
KIT, CONVERSION, DEUCE LEVER	193-41336-K005
KIT, HANDLEBAR CLAMP 22.2MM	193-41336-K006
KIT, CABLE & HOUSING, DROPPER T-HEAD	361-39642
KIT, CABLE & HOUSING, DROPPER D01 HEAD	361-41119
KIT, CABLE & HOUSING, LOCKOUT D01 HEAD	361-41484



# COMPATIBLE PRODUCT LIST

PRODUCT	COMPATIBLE HBG PRODUCTS	COMPATIBILITY NOTES
ACE DROPPER REMOTE LEVER	MANITOU JACK DROPPER SEAT POST	MY-MY22 JACK DROPPER SEAT POST MY22+ JACK DROPPER SEAT POST
	OTHER DROPPER SEAT POST	ACE MAY BE USED WITH ANY DROPPER SEAT POST THAT REQUIRES LESS THAN 7MM CABLE PULL FOR ACTUATION
	HAYES DOMINION PEACEMAKER	SRAM MATCHMAKER X MOUNTING INTERFACE
DEUCE DUAL-SUSPENSION LOCKOUT REMOTE LEVER	MANITOU KWIK TOGGLE COMPRESSION DAMPER	MY18+ MARKHOR MY21+ MACHETE COMP
	MANITOU ABSOLUTE PLUS (ABS+) COMPRESSION DAMPER	MY18+ MARKHOR MY18 MASTODON COMP MY19+ JUNIT COMP/EXPERT/PRO MY21+ R7 EXPERT/PRO (WITH ABS+ REMOTE) MY24+ MASTODON COMP MY24+ MATTOC COMP
	MANITOU VTT PRO COMPRESSION DAMPER	MY21+ R7 PRO (32MM)
	MANITOU VTT PRO CARTRIDGE DAMPER	MY25+ R8 PRO
	HAYES DOMINION PEACEMAKER	SRAM MATCHMAKER X MOUNTING INTERFACE
ACE/DEUCE & DEUCE/ACE COMBINATION REMOTE LEVER	MANITOU JACK DROPPER SEAT POST	MY17-MY22 JACK DROPPER SEAT POST MY22+ JACK DROPPER SEAT POST
	OTHER DROPPER SEAT POST	ACE MAY BE USED WITH ANY DROPPER SEAT POST THAT REQUIRES LESS THAN 7MM CABLE PULL FOR ACTUATION
	MANITOU KWIK TOGGLE COMPRESSION DAMPER	MY18+ MARKHOR MY21 MACHETE COMP
	MANITOU ABSOLUTE PLUS (ABS+) COMPRESSION DAMPER	MY18+ MARKHOR MY18 MASTODON COMP MY19+ JUNIT COMP/EXPERT/PRO MY21+ R7 EXPERT/PRO (WITH ABS+ REMOTE) MY24+ MASTODON COMP MY24+ MATTOC COMP
	MANITOU VTT PRO COMPRESSION DAMPER	MY21+ R7 PRO (32MM)
	MANITOU VTT PRO CARTRIDGE DAMPER	MY25+ R8 PRO
	OTHER COMPRESSION DAMPERS	DEUCE MAY BE USED WITH ANY COMPRESSION DAMPER OR SUSPENSION ADJUSTMENT THAT REQUIRES 18MM CABLE PULL FOR ACTUATION
HAYES DOMINION PEACEMAKER	SRAM MATCHMAKER X MOUNTING INTERFACE	



## GLOBAL HEADQUARTERS & HAYES BICYCLE GROUP USA

5800 W. Donges Bay Rd.  
Mequon, WI 53092

## HAYES BICYCLE GROUP EU

Dirnismaning 20 a  
85748 Garching (b. Munich)  
Germany

## HAYES BICYCLE GROUP ASIA

16F, No. 37, Sec. 3  
Mincyuan E. Rd.  
Zhongshan District

[facebook.com/ManitouMTB](https://facebook.com/ManitouMTB)



[instagram.com/ManitouMTB](https://instagram.com/ManitouMTB)



#ScienceofSmooth

**HAYES**

**M**  
MANITOU

**PROTAPER**

**REYNOLDS**

**SUN**  
ringle