

**INCREMENTAL VOLUME ADJUST (IVA)**

Incremental Volume Adjust (IVA) modifies the volume in the positive air spring. This allows the main air spring ramp-up to be tuned.

Increasing the air volume creates a more linear spring curve with reduced mid-stroke support and end-stroke ramp-up.

Reducing the air volume creates a more progressive spring curve with increased mid-stroke support and end-stroke ramp-up.

The air volume is modified by removing the clip-on spacers from the IVA shaft moving the piston into the desired location and reassembling the clip-on spacers to secure the piston on the IVA shaft.

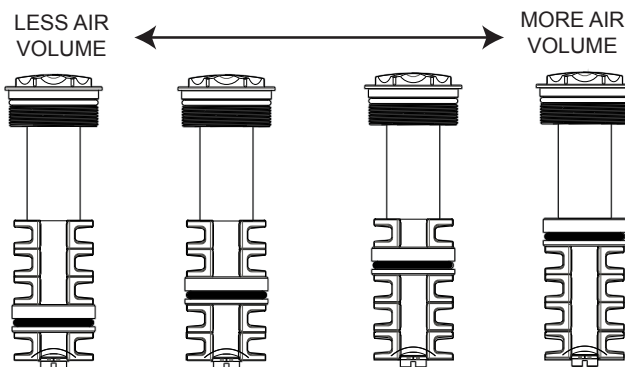

**DORADO INCREMENTAL VOLUME ADJUST (IVA) INSTALLATION & SET-UP GUIDE**

NOTE: For ease of service it is recommended that the spring leg be removed from the fork crowns.

1. Remove valve cap and attach shock-pump. Depressurize air spring, remove shock pump. Fully depress the air valve core with 3mm hex to fully evacuate any remaining pressure.
2. Remove spring end-cap on non-drive side drop-out using 26mm socket.
3. Set IVA piston to desired position. Lubricate IVA piston seal with M-prep grease.
4. Insert IVA assembly into leg. Use 26mm socket, torque to 6,8-9,0 N-m [60-80 in-lb].
5. Attach shock pump to main air spring , pressurize to recommended air pressure in chart.

Rider Weight		Dorado 203mm Spring Pressure, psi [Bar]		
lbs	Kg	Soft	Standard	Firm
>220	>100	85 [5.8]	92 [6.3]	100 [6.9]
200-220	92-100	75 [5.2]	82 [5.7]	90 [6.2]
170-199	77-91	65 [4.5]	72 [5.0]	80 [5.5]
140-169	64-76	55 [3.8]	62 [4.3]	70 [4.8]
120-139	54-63	50 [3.4]	55 [3.8]	60 [4.1]

**INCREMENTAL VOLUME ADJUST (IVA) ADJUSTMENT**

1. Remove valve cap and attach shock-pump. Depressurize air spring, remove shock pump. Fully depress the air valve core with 3mm hex to fully evacuate any remaining pressure.
2. Remove IVA assembly from fork.
3. Remove spacers from IVA shaft.
4. Set IVA piston to desired position.
5. Replace spacers to secure IVA piston in place.
6. Insert IVA assembly into leg. Torque top-cap to 6,8-9,0 N-m [60-80 in-lb].
7. Attach shock pump to main air spring , pressurize to recommended air pressure in chart.

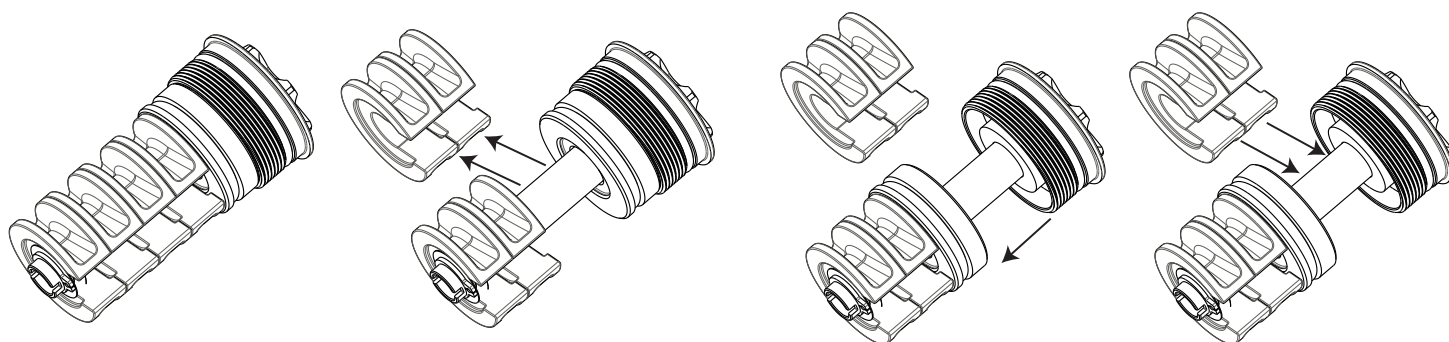

**MATTOC/MAGNUM INCREMENTAL VOLUME ADJUST (IVA) INSTALLATION & SET-UP GUIDE**

1. Remove valve cap and attach shock-pump. Depressurize air spring, remove shock pump. Fully depress the air valve core with 3mm hex to fully evacuate any remaining pressure.
2. Remove spring top cap using 24mm socket.
3. Set IVA piston to desired position. Lubricate IVA piston seal with M-prep grease.
4. Insert IVA assembly into leg. Use 24mm socket, torque to 6,8-9,0 N-m [60-80 in-lb].
5. Attach shock pump to main air spring , pressurize to recommended air pressure in chart.

Rider Weight		Mattoc Spring Pressure, psi [Bar]			
lbs	Kg	140mm	150mm	160mm	170mm
>220	>100	102 [7.0]	92 [6.3]	84 [5.8]	76 [5.2]
200-220	92-100	94 [6.5]	84 [5.8]	76 [5.2]	69 [4.8]
170-199	77-91	80 [5.5]	72 [5.0]	65 [4.5]	58 [4.0]
140-169	64-76	68 [4.7]	60 [4.1]	53 [3.7]	48 [3.3]
120-139	54-63	54 [3.7]	48 [3.3]	42 [2.9]	37 [2.6]

Rider Weight		Magnum Spring Pressure, psi [Bar]			
lbs	Kg	80mm	100/110mm	120mm	140mm
>220	>100	120 [8.3]	115 [7.9]	110 [7.6]	105 [7.2]
200-220	92-100	110 [7.6]	105 [7.2]	100 [6.9]	94 [6.5]
170-199	77-91	95 [6.3]	90 [6.2]	85 [5.9]	80 [5.5]
140-169	64-76	83 [5.7]	78 [5.4]	73 [5.0]	68 [4.7]
120-139	54-63	69 [4.8]	64 [4.4]	59 [4.0]	54 [3.7]

Mattoc/Magnum 140, 70psi, IVA Comparison

