

HAYES TRAIL GUIDE

INSTRUCTION MANUAL FOR IMPROVING
YOUR MOUNTAIN BICYCLING EXPERIENCE



 **HAYES**



HAYES





HAYES TRAIL GUIDE



MRD IVA (INCREMENTAL VOLUME ADJUST)

- Allows customized ramp-up for specific conditions or rider preference.
- Spacers are self contained for easy, self tuning without losing parts.

DH AIR SYSTEM

- Provides low weight and smooth, sensitive top-out.

AVAILABLE FOR:
MATTOC PRO / EXPERT / COMP
DORADO PRO / EXPERT

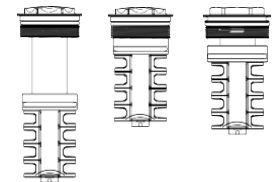
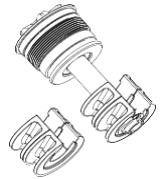



HAYES TRAIL GUIDE

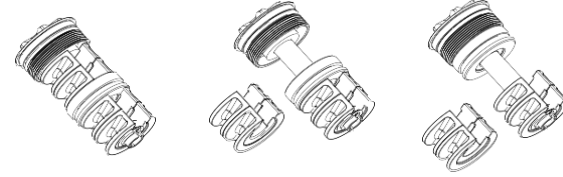

Standard Dorado Air Spring, Pressure Comparison

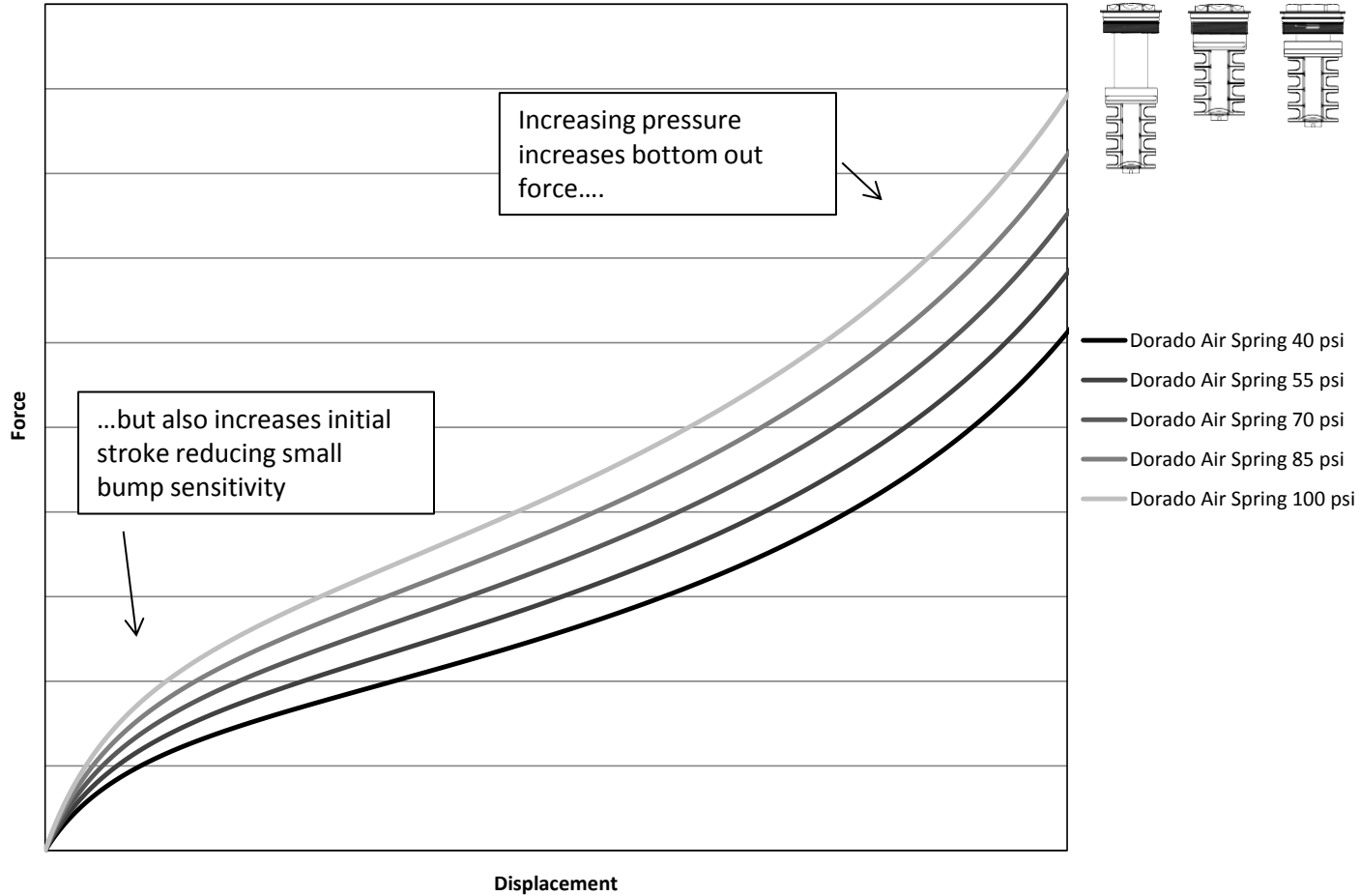



HAYES TRAIL GUIDE

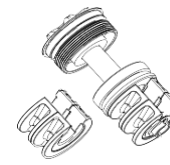

Dorado Air Spring 40 psi + IVA Spacers

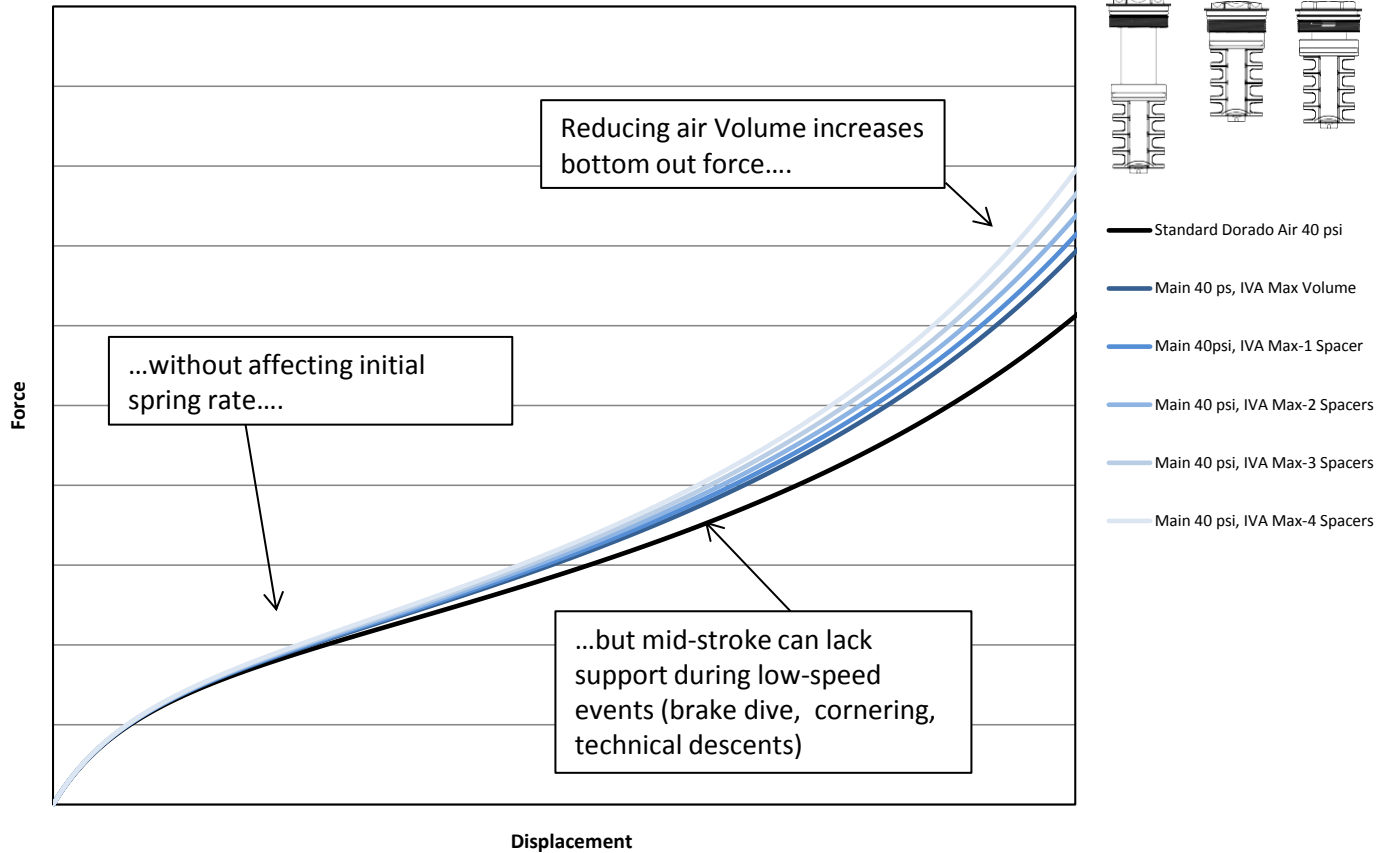



HAYES TRAIL GUIDE

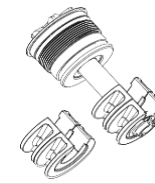
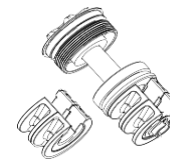

Dorado Air Spring comparison Standard vs. IVA 2 spacers installed

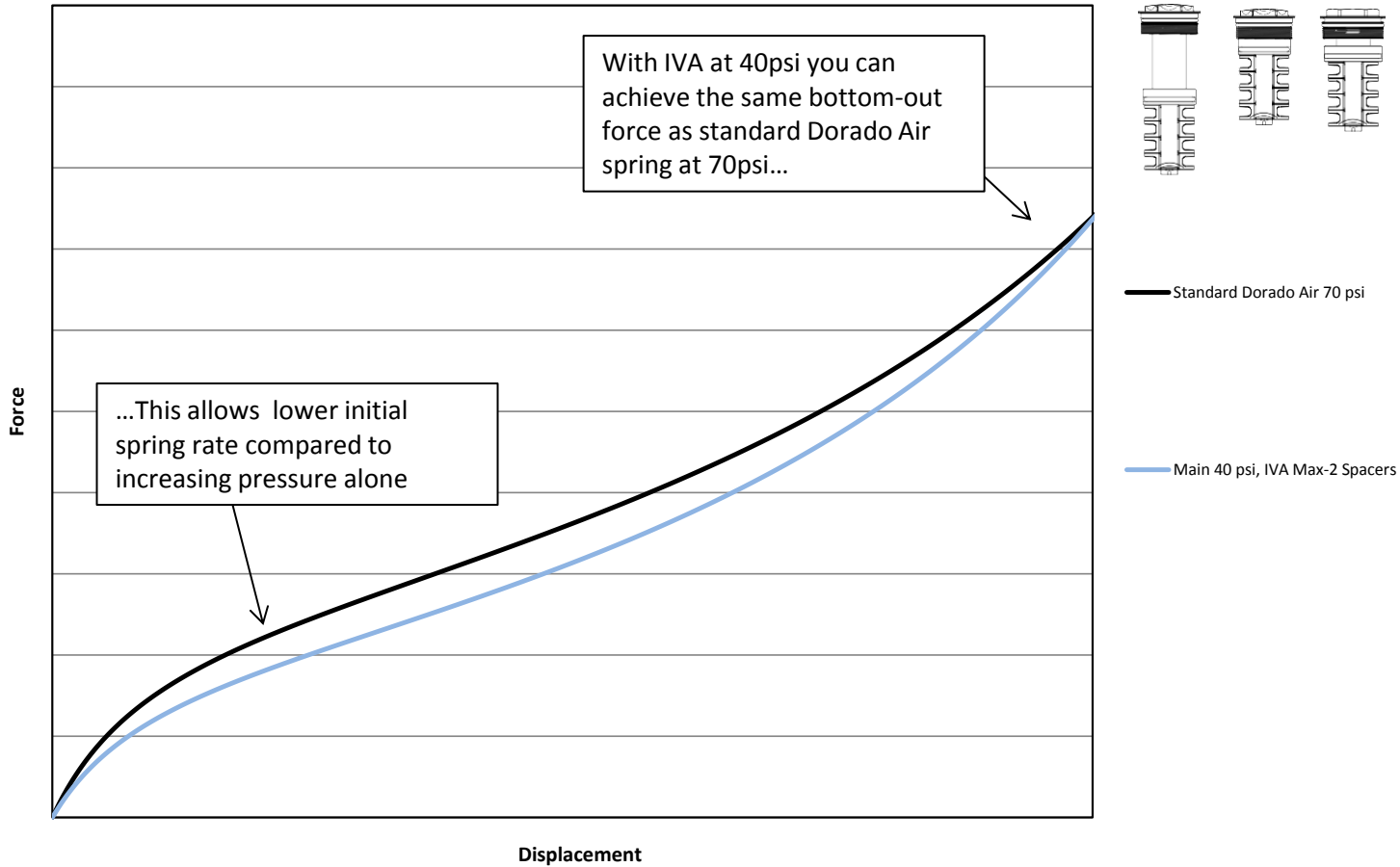



HAYES TRAIL GUIDE

Comparing Dorado Standard Spring with

IRT (Initial Rate Tune)

And

IVA (Incremental Volume Adjust)





HAYES TRAIL GUIDE

Dorado Air Spring with IVA or IRT, Equal Pressure

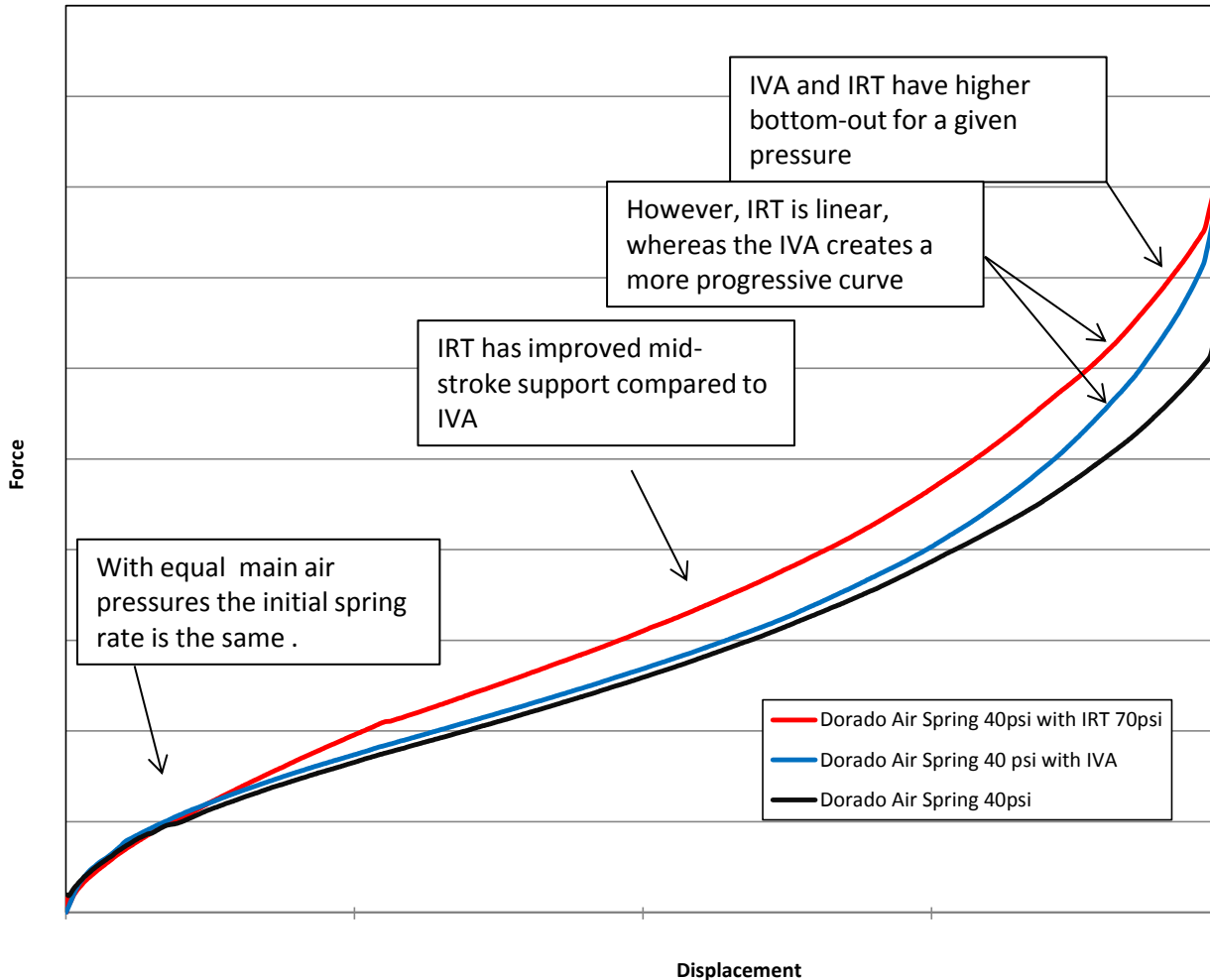



HAYES TRAIL GUIDE

Dorado Air Spring with IVA or IRT, Equal Bottom-out Force

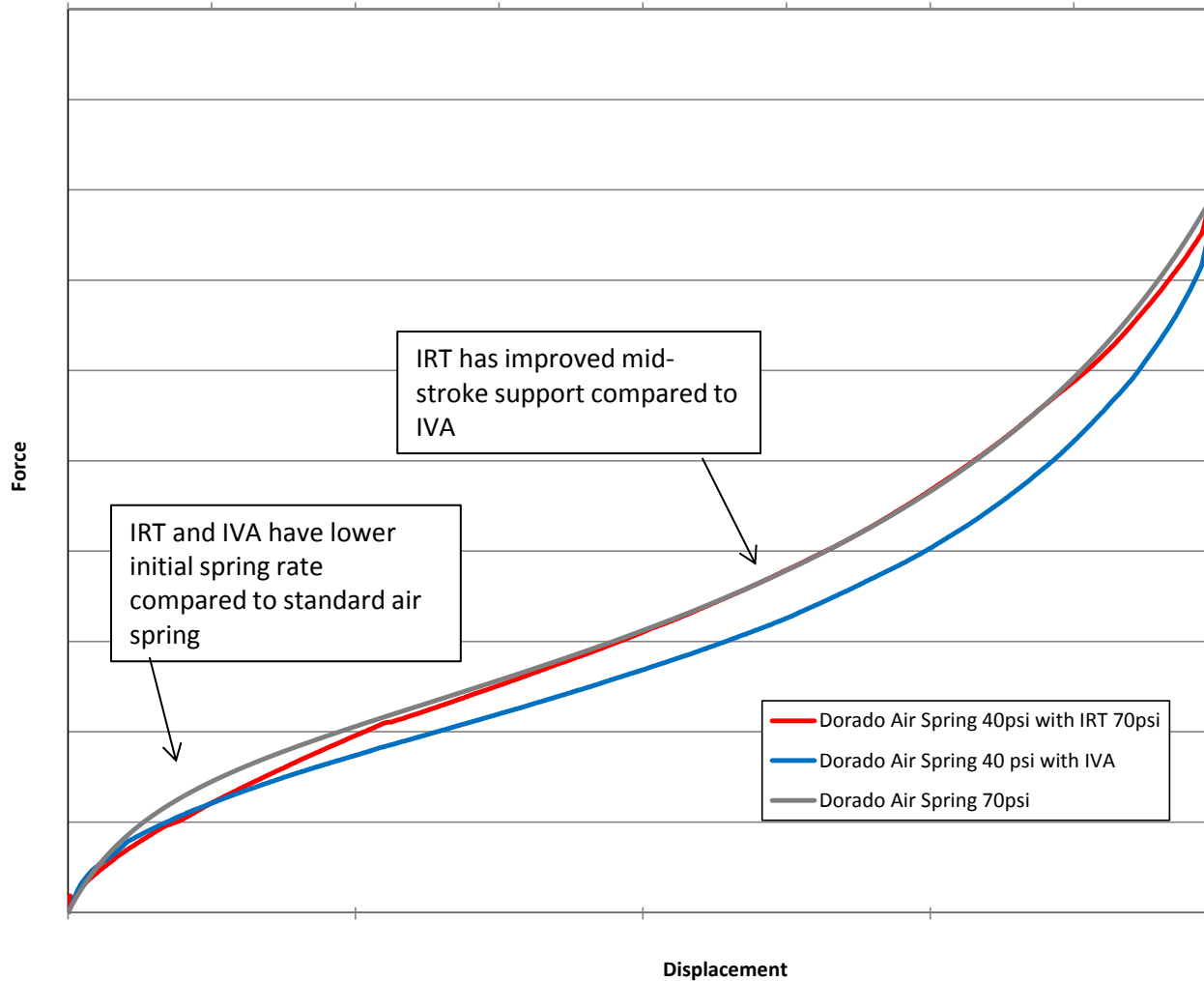



HAYES TRAIL GUIDE

What's the bottom line?

STD (Standard) vs. IVA (Incremental Volume Adjust)

IVA adds end stroke control and a simple tuning ability.

STD (Standard) vs. IRT (Infinite Rate Tune)

IRT offers better support with low set-pressures while maintaining the linearity to bottom.

IVA (Incremental Volume Adjust) vs. IRT (Infinite Rate Tune)

Key advantage of IRT is it maintains or even improves small bump compliance and builds good support in the mid-stroke (cornering and braking loads) while keeping linearity thru bottom-out.

IRT requires more user knowledge, intended for the sophisticated rider/racer.





HAYES TRAIL GUIDE

What technology is best for me?

IRT (Infinite Rate Tune)

IRT Allows rider to maintain mid-stroke support while reducing initial spring force.

Who is it for:

Riders and racers who have more extensive understanding of air spring function who want to custom tune spring rate for more sensitive initial stroke AND more supportive mid-stroke.

IVA (Incremental Volume Adjust)

IVA allows rider to tune end-stroke control simply by adjusting air volume using integrated piston spacers.

Who is it for:

Riders who want to custom tune the air spring for more sensitive initial stroke OR more progressive end-stroke.



 **HAYES**



HAYES

