

## KING CAN INSTALLATION

### Volume Adjustment/King Can Service

1. Remove snap ring and slide outer air can sleeve off of the inner can. **FIG. 1**
2. If servicing King Can, replace all O-rings and back-up ring if being used. If changing the volume of the King Can, add or remove the middle O-ring and back-up ring as shown in **FIG. 2**.
3. Lightly grease O-rings and back-up ring and slide outer air can sleeve onto inner can. Install snap ring.

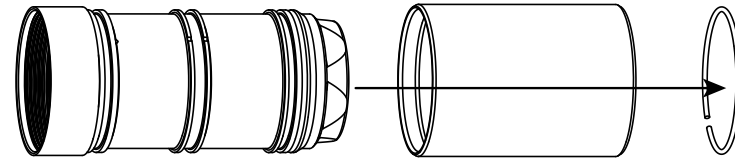

**FIG. 1**

### Spring Curves

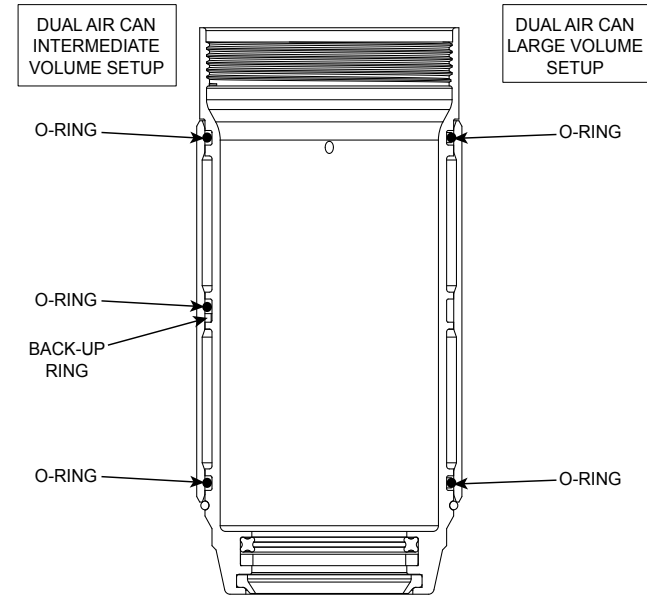
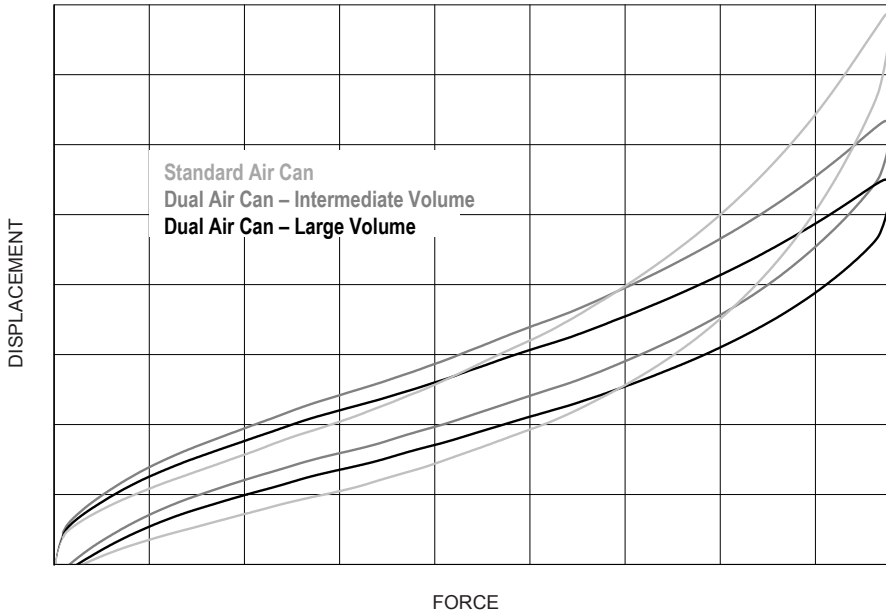

**FIG. 2**

### Service Kits Required for King Can Rebuild

- 142-31535-K002 - Air Can Seal Kit
- 142-31535-K035 - King Can Seal Kit