



## Stroker Slow Lever Kit Service Instructions

This Service kit is designed to improve the lever action on any Stroker brake which may be exhibiting signs of slow lever return. Please follow these instructions to ensure your brake is performing at its best.

**Warning:** When you need to install any of the disc brake components, that installation work should be done by a qualified technician with the proper tools. Improper installation could cause severe or fatal injuries.

**Warning:** With use, disc brake components may become very hot. Always allow components to cool before attempting to service your bike

### Service Kit Contents

Description	qty
MC lubricating grease	1
Applicator	1
MC piston	2
MC return spring	2
MC Retaining snap ring	2
Trail/Gram/Ace pivot pin	2
Pivot pin set screw	2
Trail/Gram/Ace pivot bushing	4
Stroker bleed fitting	1

1. Remove Lever Blade
  - a. Stroker Trail/Carbon/Gram/Ace
    - i. Loosen lever set screw with 2.0 mm Allen wrench.
    - ii. Push the Lever Pivot Pin through the lever.
    - iii. Remove the lever pivot bushings.
    - iv. Using the tool-free lever reach adjuster, thread the lever blade off the push rod.
 

**Caution:** Do not remove the lever reach adjuster from the lever blade, as some of the pieces could become lost.
    - v. Set the lever aside.
  - b. Stroker Ryde
    - i. Carefully remove the spring clip from one side of the lever pivot pin.
 

**Warning:** Always wear protective eyewear when removing or installing spring clips.
    - ii. Push Lever Pivot Pin through lever.
    - iii. Insert a 2.5mm Allen wrench into the end of the push rod.
    - iv. Turn the push rod clockwise to thread it through the lever blade.
    - v. Set the lever aside.
2. Remove the pushrod retaining ring with a snap ring pliers.
 

**Warning:** Always wear protective eyewear when removing or installing snap rings.
3. Remove the pushrod and retaining washer.
4. Apply a liberal amount of the special grease to the applicator.
 

**Caution:** Use only the grease provided in this kit. Other lubricants could damage the piston seals.
5. Use the applicator to push the piston into the master cylinder. Apply grease to the sides of the bore while the piston is depressed. Work the piston until it moves freely.
6. When the sides of the bore are lubricated, the piston will pop up. Remove the piston and return spring.
7. Assemble the replacement return spring and piston. Lubricate the replacement piston and piston o-ring with the special grease.
8. Install the replacement return spring and piston assembly.
9. Replace the pushrod and retaining washer.
10. Install the new retaining ring using a snap ring pliers.
 

**Warning:** Always wear protective eyewear when removing or installing snap rings.
11. Install the lever Blade.
  - a. Stroker Trail/Carbon/Gram/Ace
    - i. Using the tool-free lever reach adjuster, thread the lever blade onto the push rod.
    - ii. Install the new lever pivot bushings.
    - iii. Install the new lever pivot pin.
    - iv. Install the new lever pin set screw with 2.0 mm Allen wrench.
  - b. Stroker Ryde
    - i. Using a 2.5mm Allen wrench, thread the lever blade onto the push rod.
    - ii. Replace the lever pivot pin.
    - iii. Replace the spring clip to secure the lever pin.
 

**Warning:** Always wear protective eyewear when removing or installing spring clips.
12. Test the lever action to see that the lever returns quickly.
13. Bleed the brake. Complete service instructions can be found online at [www.hayesdiscbrake.com](http://www.hayesdiscbrake.com). Apply the brake and check for a firm hydraulic feel.

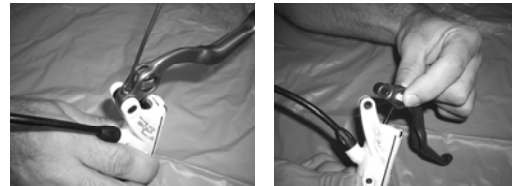

Stroker Trail/Carbon/Gram/Ace Lever Removal



Stroker Ryde Lever Removal



Remove the snap ring



Special grease and applicator



Depress piston and apply special lube to walls of master cylinder bore



Install new piston and return spring. Lubricate piston and o-ring.

