

BLEED TOOL

1. Relieve pressure from tool by depressing the Schrader valve.
2. Remove top cap. Fill tool ~3/4 with 5wt Maxima Fork Fluid and replace top cap.
3. Hold shock shaft to keep it from turning and thread tool onto shaft until you can no longer turn by hand. Installed, the shaft threads should not be visible.
4. Add 100-150 psi pressure to the tool via the Schrader valve.
5. Using a Phillips screwdriver slowly open the bleed screw on the air piston until oil flows out. Do not completely remove screw, only unthread until oil is freely flowing from the screw.
6. While under pressure, use the tool to depress the shock shaft. Release the tool, the air pressure should return the shaft and tool to the fully extended position on it's own. Repeat this step until no more bubbles are coming out of bleed screw. Minimum of 5 times.
6. Relieve tool pressure and unthread tool from shaft.

NOTE: Do not shake oil filled tool as this can aerate the oil and provide a bad bleed.

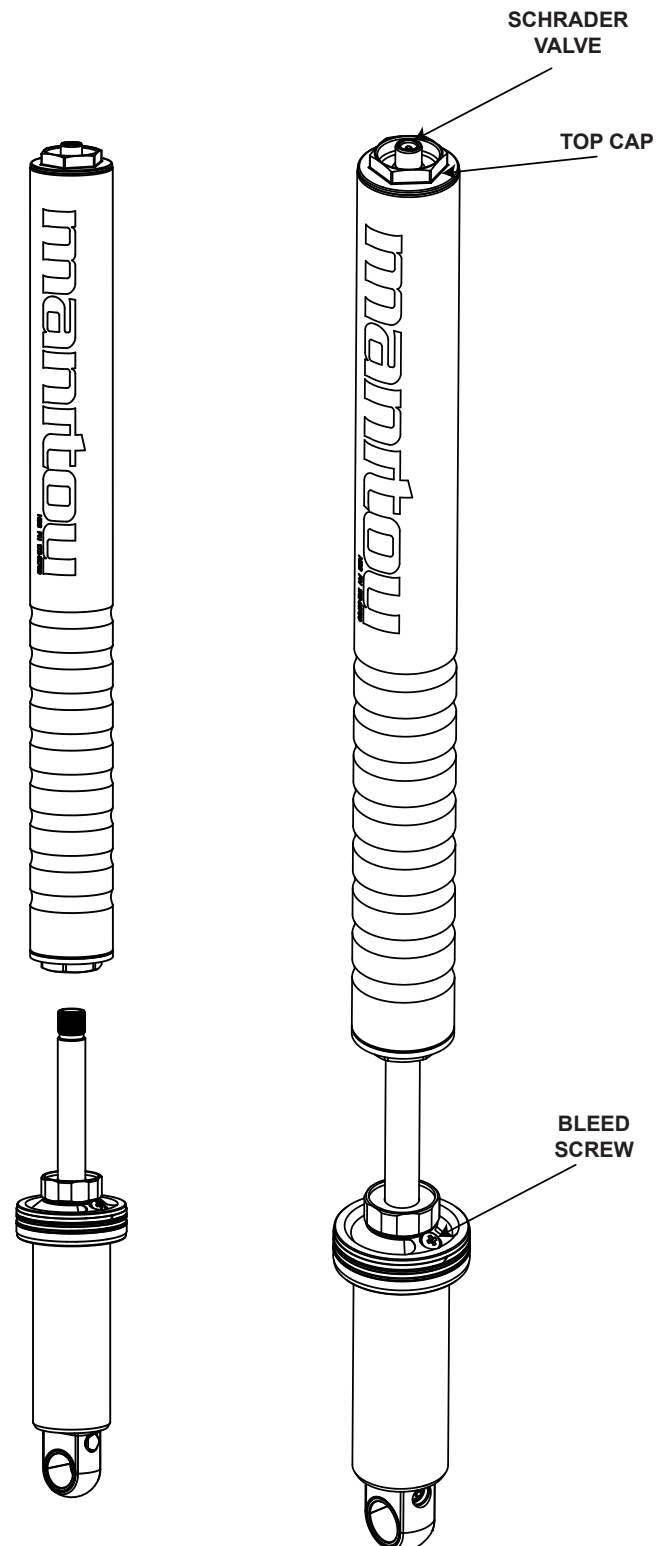

For further instructions on service tool usage watch the McLeod Service videos at:
www.manitoumtb.com/support/